

Base Plate Connector Clamps

Aluminum / Stainless Steel, with 4 Mounting Holes

SPECIFICATION

Identification No.

No. **2**: With stainless steel socket cap screw DIN 912

Aluminum

- Powder coated
Black, RAL 9005, textured finish **SW**
- Plain, matte shot-blasted **BL**

Stainless steel AISI CF-8 **NI**

Matte shot-blasted

Socket cap screws DIN 912

Stainless Steel AISI 304

Hex nuts DIN 985

Stainless Steel AISI 304

Self-locking via polyamide ring



INFORMATION

The clamping bore of base plate connector clamps GN 162 is mechanically machined and designed for construction tubes GN 990 (see page 1902) or DIN 2391, DIN 2395 and DIN 2462.

At the screw location **z**, the socket cap screw reduces the bore cross-section for clamping.

TECHNICAL INFORMATION

- Stainless Steel Characteristics (see page A26)

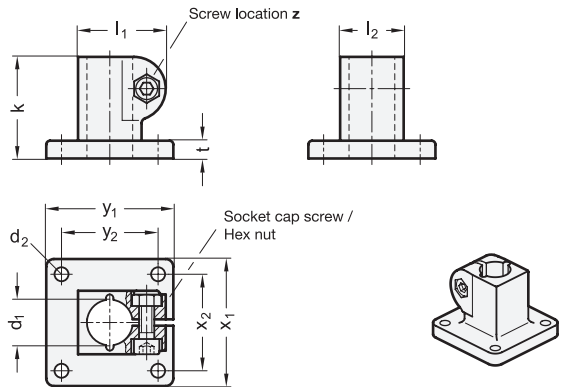

* Complete with

SW **BL**
RAL9005 Plain

GN 162-AL

Description	d ₁ Bore	d ₂	k Clamping length	l ₁	l ₂	t	x ₁	x ₂	y ₁	y ₂	z Screw location	⚖
GN 162-B10-2-*	B 10	5.5	40	34.5	25	7	50	38	50	38	M6-20	97
GN 162-B12-2-*	B 12	5.5	40	34.5	25	7	50	38	50	38	M6-20	95
GN 162-B14-2-*	B 14	5.5	40	34.5	25	7	50	38	50	38	M6-20	89
GN 162-B15-2-*	B 15	5.5	40	34.5	25	7	50	38	50	38	M6-20	87
GN 162-B16-2-*	B 16	5.5	40	34.5	25	7	50	38	50	38	M6-20	85
GN 162-B18-2-*	B 18	5.5	40	34.5	25	7	50	38	50	38	M6-20	80

GN 162-NI

STAINLESS STEEL

Description	d ₁ Bore	d ₂	k Clamping length	l ₁	l ₂	t	x ₁	x ₂	y ₁	y ₂	z Screw location	⚖
GN 162-B12-2-NI	B 12	5.5	40	34.5	25	7	50	38	50	38	M6-20	238
GN 162-B14-2-NI	B 14	5.5	40	34.5	25	7	50	38	50	38	M6-20	227
GN 162-B15-2-NI	B 15	5.5	40	34.5	25	7	50	38	50	38	M6-20	213
GN 162-B16-2-NI	B 16	5.5	40	34.5	25	7	50	38	50	38	M6-20	207
GN 162-B18-2-NI	B 18	5.5	40	34.5	25	7	50	38	50	38	M6-20	200
GN 162-B20-2-NI	B 20	5.5	40	34.5	25	7	50	38	50	38	M6-20	180

Weight SW